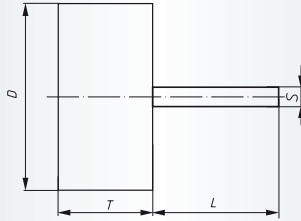
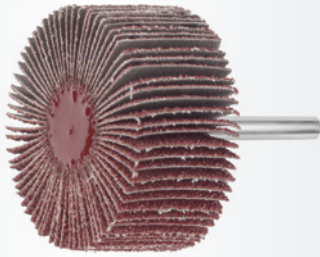

SFL, Flap wheels
Ordering example: A2200020103080

Packing unit:

10 pcs. per type

Further dimensions, qualities and shank lengths on request

NK = reg. Aluminium Oxide

Description	Grits	D mm	T mm	S mm	L mm	n recom. (1/min)	n max. (1/min)	Product-Number	recommended for	
SFL 01010.03	NK 80	10	10	3	40	26.000	35.000	A2200010103080	1 2 3 4 5 6 7 8	■
SFL 01010.03	NK 120	10	10	3	40	26.000	35.000	A2200010103120	1 2 3 4 5 6 7 8	■
SFL 01010.03	NK 150	10	10	3	40	26.000	35.000	A2200010103150	1 2 3 4 5 6 7 8	■
NEW SFL 01010.03	NK 240	10	10	3	40	26.000	35.000	A2200010103240	1 2 3 4 5 6 7 8	■
NEW SFL 01015.03	NK 80	10	15	3	40	26.000	35.000	A2200010153080	1 2 3 4 5 6 7 8	■
NEW SFL 01510.03	NK 150	15	10	3	40	24.000	35.000	A2200015103150	1 2 3 4 5 6 7 8	■
SFL 01515.03	NK 80	15	15	3	40	24.000	35.000	A2200015153080	1 2 3 4 5 6 7 8	■
SFL 01515.03	NK 120	15	15	3	40	24.000	35.000	A2200015153120	1 2 3 4 5 6 7 8	■
SFL 01515.03	NK 150	15	15	3	40	24.000	35.000	A2200015153150	1 2 3 4 5 6 7 8	■
SFL 02005.06	NK 120	20	5	6	40	20.000	28.000	A2200020056120	1 2 3 4 5 6 7 8	■
SFL 02010.03	NK 80	20	10	3	40	20.000	28.000	A2200020103080	1 2 3 4 5 6 7 8	■
SFL 02010.03	NK 120	20	10	3	40	20.000	28.000	A2200020103120	1 2 3 4 5 6 7 8	■
SFL 02010.03	NK 150	20	10	3	40	20.000	28.000	A2200020103150	1 2 3 4 5 6 7 8	■
NEW SFL 02010.03	NK 320	20	10	3	40	20.000	28.000	A2200020103320	1 2 3 4 5 6 7 8	■
SFL 02010.06	NK 80	20	10	6	40	20.000	28.000	A2200020106080	1 2 3 4 5 6 7 8	■
SFL 02010.06	NK 120	20	10	6	40	20.000	28.000	A2200020106120	1 2 3 4 5 6 7 8	■
NEW SFL 02015.06	NK 60	20	15	6	40	20.000	28.000	A2200020156060	1 2 3 4 5 6 7 8	■
SFL 02015.06	NK 80	20	15	6	40	20.000	28.000	A2200020156080	1 2 3 4 5 6 7 8	■
SFL 02015.06	NK 120	20	15	6	40	20.000	28.000	A2200020156120	1 2 3 4 5 6 7 8	■
SFL 02015.06	NK 150	20	15	6	40	20.000	28.000	A2200020156150	1 2 3 4 5 6 7 8	■
NEW SFL 02015.06	NK 240	20	15	6	40	20.000	28.000	A2200020156240	1 2 3 4 5 6 7 8	■
SFL 02505.03	NK 120	25	5	3	40	16.000	18.000	A2200025053120	1 2 3 4 5 6 7 8	■
SFL 02510.03	NK 80	25	10	3	40	16.000	18.000	A2200025103080	1 2 3 4 5 6 7 8	■
SFL 02510.03	NK 120	25	10	3	40	16.000	18.000	A2200025103120	1 2 3 4 5 6 7 8	■
SFL 02510.03	NK 150	25	10	3	40	16.000	18.000	A2200025103150	1 2 3 4 5 6 7 8	■
SFL 02515.06	NK 80	25	15	6	40	16.000	18.000	A2200025156080	1 2 3 4 5 6 7 8	■
SFL 02515.06	NK 120	25	15	6	40	16.000	18.000	A2200025156120	1 2 3 4 5 6 7 8	■
SFL 02515.06	NK 150	25	15	6	40	16.000	18.000	A2200025156150	1 2 3 4 5 6 7 8	■
SFL 02525.06	NK 80	25	25	6	40	16.000	18.000	A2200025256080	1 2 3 4 5 6 7 8	■
SFL 02525.06	NK 150	25	25	6	40	16.000	18.000	A2200025256150	1 2 3 4 5 6 7 8	■
SFL 03005.03	NK 60	30	5	3	40	16.000	18.000	A2200030053060	1 2 3 4 5 6 7 8	■
SFL 03005.03	NK 80	30	5	3	40	16.000	18.000	A2200030053080	1 2 3 4 5 6 7 8	■

The stated maximum operating speed only applies to a maximum overhang L_0 of 20 mm. Other overhang dimensions must be calculated separately.

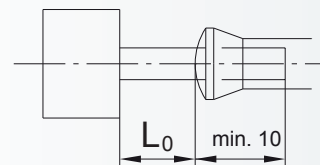

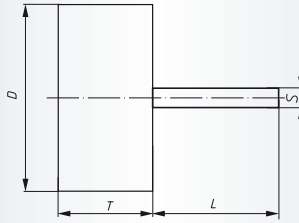
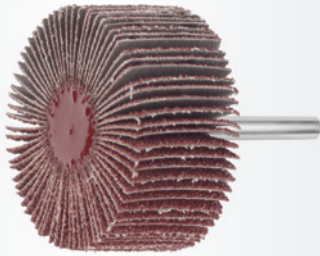
SFL, Flap wheels
Ordering example: A2200030053120

Packing unit:

10 pcs. per type

Further dimensions, qualities and shank lengths on request

NK = reg. Aluminium Oxide

Description	Grits	D mm	T mm	S mm	L mm	n recom. (1/min)	n max. (1/min)	Product-Number	recommended for	
SFL 03005.03	NK 120	30	5	3	40	16.000	18.000	A2200030053120	1 2 3 4 5 6 7 8	■
SFL 03005.03	NK 150	30	5	3	40	16.000	18.000	A2200030053150	1 2 3 4 5 6 7 8	■
SFL 03005.03	NK 240	30	5	3	40	16.000	18.000	A2200030053240	1 2 3 4 5 6 7 8	■
SFL 03005.03	NK 320	30	5	3	40	16.000	18.000	A2200030053320	1 2 3 4 5 6 7 8	■
SFL 03005.06	NK 60	30	5	6	40	16.000	18.000	A2200030056060	1 2 3 4 5 6 7 8	■
SFL 03005.06	NK 80	30	5	6	40	16.000	18.000	A2200030056080	1 2 3 4 5 6 7 8	■
SFL 03005.06	NK 120	30	5	6	40	16.000	18.000	A2200030056120	1 2 3 4 5 6 7 8	■
SFL 03005.06	NK 150	30	5	6	40	16.000	18.000	A2200030056150	1 2 3 4 5 6 7 8	■
SFL 03005.06	NK 240	30	5	6	40	16.000	18.000	A2200030056240	1 2 3 4 5 6 7 8	■
SFL 03005.06	NK 320	30	5	6	40	16.000	18.000	A2200030056320	1 2 3 4 5 6 7 8	■
SFL 03010.03	NK 60	30	10	3	40	16.000	18.000	A2200030103060	1 2 3 4 5 6 7 8	■
SFL 03010.03	NK 80	30	10	3	40	16.000	18.000	A2200030103080	1 2 3 4 5 6 7 8	■
SFL 03010.03	NK 120	30	10	3	40	16.000	18.000	A2200030103120	1 2 3 4 5 6 7 8	■
SFL 03010.03	NK 150	30	10	3	40	16.000	18.000	A2200030103150	1 2 3 4 5 6 7 8	■
SFL 03010.03	NK 240	30	10	3	40	16.000	18.000	A2200030103240	1 2 3 4 5 6 7 8	■
SFL 03010.03	NK 320	30	10	3	40	16.000	18.000	A2200030103320	1 2 3 4 5 6 7 8	■
SFL 03010.06	NK 60	30	10	6	40	16.000	18.000	A2200030106060	1 2 3 4 5 6 7 8	■
SFL 03010.06	NK 80	30	10	6	40	16.000	18.000	A2200030106080	1 2 3 4 5 6 7 8	■
SFL 03010.06	NK 120	30	10	6	40	16.000	18.000	A2200030106120	1 2 3 4 5 6 7 8	■
SFL 03010.06	NK 150	30	10	6	40	16.000	18.000	A2200030106150	1 2 3 4 5 6 7 8	■
SFL 03010.06	NK 240	30	10	6	40	16.000	18.000	A2200030106240	1 2 3 4 5 6 7 8	■
SFL 03010.06	NK 320	30	10	6	40	16.000	18.000	A2200030106320	1 2 3 4 5 6 7 8	■
SFL 03015.06	NK 60	30	15	6	40	16.000	18.000	A2200030156060	1 2 3 4 5 6 7 8	■
SFL 03015.06	NK 80	30	15	6	40	16.000	18.000	A2200030156080	1 2 3 4 5 6 7 8	■
SFL 03015.06	NK 120	30	15	6	40	16.000	18.000	A2200030156120	1 2 3 4 5 6 7 8	■
SFL 03015.06	NK 150	30	15	6	40	16.000	18.000	A2200030156150	1 2 3 4 5 6 7 8	■
SFL 03020.06	NK 40	30	20	6	40	16.000	18.000	A2200030206040	1 2 3 4 5 6 7 8	■
SFL 03020.06	NK 60	30	20	6	40	16.000	18.000	A2200030206060	1 2 3 4 5 6 7 8	■
SFL 03020.06	NK 80	30	20	6	40	16.000	18.000	A2200030206080	1 2 3 4 5 6 7 8	■
SFL 04010.03	NK 60	40	10	3	40	12.000	18.000	A2200040103060	1 2 3 4 5 6 7 8	■
SFL 04010.03	NK 80	40	10	3	40	12.000	18.000	A2200040103080	1 2 3 4 5 6 7 8	■
SFL 04010.03	NK 120	40	10	3	40	12.000	18.000	A2200040103120	1 2 3 4 5 6 7 8	■

The stated maximum operating speed only applies to a maximum overhang L_0 of 20 mm. Other overhang dimensions must be calculated separately.

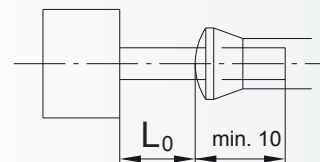

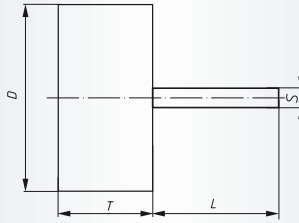
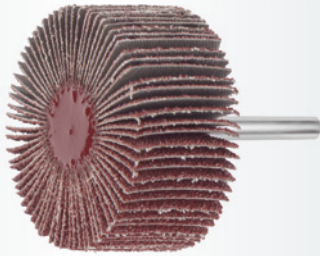
SFL, Flap wheels
Ordering example: A2200040103150

Packing unit:

10 pcs. per type

Further dimensions, qualities and shank lengths on request

NK = reg. Aluminium Oxide

Description	Grits	D mm	T mm	S mm	L mm	n recom. (1/min)	n max. (1/min)	Product-Number	recommended for	
SFL 04010.03	NK 150	40	10	3	40	12.000	18.000	A2200040103150	1 2 3 4 5 6 7 8	■
SFL 04010.06	NK 60	40	10	6	40	12.000	18.000	A2200040106060	1 2 3 4 5 6 7 8	■
SFL 04010.06	NK 80	40	10	6	40	12.000	18.000	A2200040106080	1 2 3 4 5 6 7 8	■
SFL 04010.06	NK 120	40	10	6	40	12.000	18.000	A2200040106120	1 2 3 4 5 6 7 8	■
SFL 04010.06	NK 150	40	10	6	40	12.000	18.000	A2200040106150	1 2 3 4 5 6 7 8	■
SFL 04010.06	NK 240	40	10	6	40	12.000	18.000	A2200040106240	1 2 3 4 5 6 7 8	■
SFL 04010.06	NK 320	40	10	6	40	12.000	18.000	A2200040106320	1 2 3 4 5 6 7 8	■
SFL 04015.06	NK 40	40	15	6	40	12.000	18.000	A2200040156040	1 2 3 4 5 6 7 8	■
SFL 04015.06	NK 60	40	15	6	40	12.000	18.000	A2200040156060	1 2 3 4 5 6 7 8	■
SFL 04015.06	NK 80	40	15	6	40	12.000	18.000	A2200040156080	1 2 3 4 5 6 7 8	■
SFL 04015.06	NK 120	40	15	6	40	12.000	18.000	A2200040156120	1 2 3 4 5 6 7 8	■
SFL 04015.06	NK 150	40	15	6	40	12.000	18.000	A2200040156150	1 2 3 4 5 6 7 8	■
SFL 04015.06	NK 240	40	15	6	40	12.000	18.000	A2200040156240	1 2 3 4 5 6 7 8	■
SFL 04015.06	NK 320	40	15	6	40	12.000	18.000	A2200040156320	1 2 3 4 5 6 7 8	■
SFL 04020.06	NK 40	40	20	6	40	12.000	18.000	A2200040206040	1 2 3 4 5 6 7 8	■
SFL 04020.06	NK 60	40	20	6	40	12.000	18.000	A2200040206060	1 2 3 4 5 6 7 8	■
SFL 04020.06	NK 80	40	20	6	40	12.000	18.000	A2200040206080	1 2 3 4 5 6 7 8	■
SFL 04020.06	NK 120	40	20	6	40	12.000	18.000	A2200040206120	1 2 3 4 5 6 7 8	■
SFL 04020.06	NK 150	40	20	6	40	12.000	18.000	A2200040206150	1 2 3 4 5 6 7 8	■
SFL 04020.06	NK 240	40	20	6	40	12.000	18.000	A2200040206240	1 2 3 4 5 6 7 8	■
SFL 04020.06	NK 320	40	20	6	40	12.000	18.000	A2200040206320	1 2 3 4 5 6 7 8	■
SFL 05010.06	NK 60	50	10	6	40	9.000	12.000	A2200050106060	1 2 3 4 5 6 7 8	■
SFL 05010.06	NK 80	50	10	6	40	9.000	12.000	A2200050106080	1 2 3 4 5 6 7 8	■
SFL 05010.06	NK 120	50	10	6	40	9.000	12.000	A2200050106120	1 2 3 4 5 6 7 8	■
SFL 05010.06	NK 150	50	10	6	40	9.000	12.000	A2200050106150	1 2 3 4 5 6 7 8	■
SFL 05010.06	NK 240	50	10	6	40	9.000	12.000	A2200050106240	1 2 3 4 5 6 7 8	■
SFL 05015.06	NK 40	50	15	6	40	9.000	12.000	A2200050156040	1 2 3 4 5 6 7 8	■
SFL 05015.06	NK 60	50	15	6	40	9.000	12.000	A2200050156060	1 2 3 4 5 6 7 8	■
SFL 05015.06	NK 80	50	15	6	40	9.000	12.000	A2200050156080	1 2 3 4 5 6 7 8	■
SFL 05015.06	NK 120	50	15	6	40	9.000	12.000	A2200050156120	1 2 3 4 5 6 7 8	■
SFL 05015.06	NK 150	50	15	6	40	9.000	12.000	A2200050156150	1 2 3 4 5 6 7 8	■
SFL 05015.06	NK 240	50	15	6	40	9.000	12.000	A2200050156240	1 2 3 4 5 6 7 8	■

The stated maximum operating speed only applies to a maximum overhang L_0 of 20 mm. Other overhang dimensions must be calculated separately.

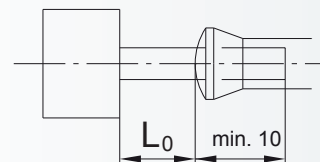

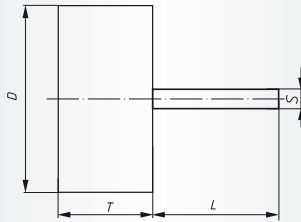
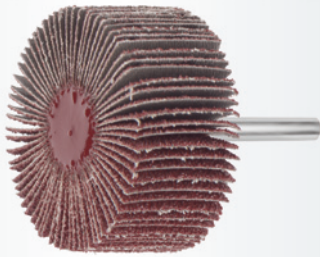
SFL, Flap wheels
Ordering example: A2200050156320

Packing unit:

10 pcs. per type

Further dimensions, qualities and shank lengths on request

NK = reg. Aluminium Oxide

Description	Grits	D mm	T mm	S mm	L mm	n recom. (1/min)	n max. (1/min)	Product-Number	recommended for	
SFL 05015.06	NK 320	50	15	6	40	9.000	12.000	A2200050156320	1 2 3 4 5 6 7 8	■
SFL 05020.06	NK 40	50	20	6	40	9.000	12.000	A2200050206040	1 2 3 4 5 6 7 8	■
SFL 05020.06	NK 60	50	20	6	40	9.000	12.000	A2200050206060	1 2 3 4 5 6 7 8	■
SFL 05020.06	NK 80	50	20	6	40	9.000	12.000	A2200050206080	1 2 3 4 5 6 7 8	■
SFL 05020.06	NK 120	50	20	6	40	9.000	12.000	A2200050206120	1 2 3 4 5 6 7 8	■
SFL 05020.06	NK 150	50	20	6	40	9.000	12.000	A2200050206150	1 2 3 4 5 6 7 8	■
SFL 05020.06	NK 240	50	20	6	40	9.000	12.000	A2200050206240	1 2 3 4 5 6 7 8	■
SFL 05020.06	NK 320	50	20	6	40	9.000	12.000	A2200050206320	1 2 3 4 5 6 7 8	■
SFL 05030.06	NK 60	50	30	6	40	9.000	12.000	A2200050306060	1 2 3 4 5 6 7 8	■
SFL 05030.06	NK 80	50	30	6	40	9.000	12.000	A2200050306080	1 2 3 4 5 6 7 8	■
SFL 05030.06	NK 120	50	30	6	40	9.000	12.000	A2200050306120	1 2 3 4 5 6 7 8	■
SFL 05030.06	NK 150	50	30	6	40	9.000	12.000	A2200050306150	1 2 3 4 5 6 7 8	■
SFL 05030.06	NK 320	50	30	6	40	9.000	12.000	A2200050306320	1 2 3 4 5 6 7 8	■
SFL 06015.06	NK 40	60	15	6	40	8.000	12.000	A2200060156040	1 2 3 4 5 6 7 8	■
SFL 06015.06	NK 60	60	15	6	40	8.000	12.000	A2200060156060	1 2 3 4 5 6 7 8	■
SFL 06015.06	NK 80	60	15	6	40	8.000	12.000	A2200060156080	1 2 3 4 5 6 7 8	■
SFL 06015.06	NK 120	60	15	6	40	8.000	12.000	A2200060156120	1 2 3 4 5 6 7 8	■
SFL 06015.06	NK 150	60	15	6	40	8.000	12.000	A2200060156150	1 2 3 4 5 6 7 8	■
SFL 06015.06	NK 240	60	15	6	40	8.000	12.000	A2200060156240	1 2 3 4 5 6 7 8	■
SFL 06015.06	NK 320	60	15	6	40	8.000	12.000	A2200060156320	1 2 3 4 5 6 7 8	■
SFL 06020.06	NK 40	60	20	6	40	8.000	12.000	A2200060206040	1 2 3 4 5 6 7 8	■
SFL 06020.06	NK 60	60	20	6	40	8.000	12.000	A2200060206060	1 2 3 4 5 6 7 8	■
SFL 06020.06	NK 80	60	20	6	40	8.000	12.000	A2200060206080	1 2 3 4 5 6 7 8	■
SFL 06020.06	NK 120	60	20	6	40	8.000	12.000	A2200060206120	1 2 3 4 5 6 7 8	■
SFL 06020.06	NK 150	60	20	6	40	8.000	12.000	A2200060206150	1 2 3 4 5 6 7 8	■
SFL 06020.06	NK 240	60	20	6	40	8.000	12.000	A2200060206240	1 2 3 4 5 6 7 8	■
SFL 06020.06	NK 320	60	20	6	40	8.000	12.000	A2200060206320	1 2 3 4 5 6 7 8	■
SFL 06030.06	NK 40	60	30	6	40	8.000	12.000	A2200060306040	1 2 3 4 5 6 7 8	■
SFL 06030.06	NK 60	60	30	6	40	8.000	12.000	A2200060306060	1 2 3 4 5 6 7 8	■
SFL 06030.06	NK 80	60	30	6	40	8.000	12.000	A2200060306080	1 2 3 4 5 6 7 8	■
SFL 06030.06	NK 120	60	30	6	40	8.000	12.000	A2200060306120	1 2 3 4 5 6 7 8	■
SFL 06030.06	NK 150	60	30	6	40	8.000	12.000	A2200060306150	1 2 3 4 5 6 7 8	■

The stated maximum operating speed only applies to a maximum overhang L_0 of 20 mm. Other overhang dimensions must be calculated separately.

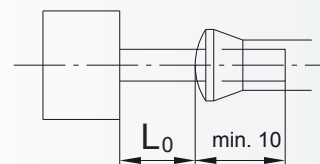

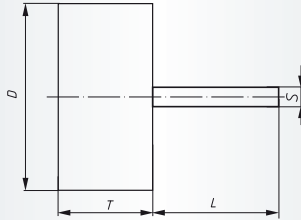
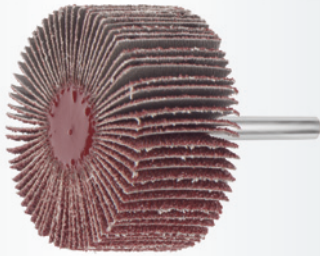
SFL, Flap wheels
Ordering example: A2200060306240

Packing unit:

10 pcs. per type

Further dimensions, qualities and shank lengths on request

NK = reg. Aluminium Oxide

Description	Grits	D mm	T mm	S mm	L mm	n recom. (1/min)	n max. (1/min)	Product-Number	recommended for	
SFL 06030.06	NK 240	60	30	6	40	8.000	12.000	A2200060306240	1 2 3 4 5 6 7 8	■
SFL 06030.06	NK 320	60	30	6	40	8.000	12.000	A2200060306320	1 2 3 4 5 6 7 8	■
SFL 06040.06	NK 40	60	40	6	40	8.000	12.000	A2200060406040	1 2 3 4 5 6 7 8	■
SFL 06040.06	NK 60	60	40	6	40	8.000	12.000	A2200060406060	1 2 3 4 5 6 7 8	■
SFL 06040.06	NK 80	60	40	6	40	8.000	12.000	A2200060406080	1 2 3 4 5 6 7 8	■
SFL 06040.06	NK 120	60	40	6	40	8.000	12.000	A2200060406120	1 2 3 4 5 6 7 8	■
SFL 06040.06	NK 150	60	40	6	40	8.000	12.000	A2200060406150	1 2 3 4 5 6 7 8	■
SFL 06040.06	NK 240	60	40	6	40	8.000	12.000	A2200060406240	1 2 3 4 5 6 7 8	■
SFL 06040.06	NK 320	60	40	6	40	8.000	12.000	A2200060406320	1 2 3 4 5 6 7 8	■
SFL 06050.06	NK 60	60	50	6	40	8.000	8.500	A2200060506060	1 2 3 4 5 6 7 8	■
SFL 06050.06	NK 80	60	50	6	40	8.000	8.500	A2200060506080	1 2 3 4 5 6 7 8	■
SFL 06050.06	NK 120	60	50	6	40	8.000	8.500	A2200060506120	1 2 3 4 5 6 7 8	■
SFL 06050.06	NK 150	60	50	6	40	8.000	8.500	A2200060506150	1 2 3 4 5 6 7 8	■
SFL 06050.06	NK 240	60	50	6	40	8.000	8.500	A2200060506240	1 2 3 4 5 6 7 8	■
SFL 08015.06	NK 60	80	15	6	40	6.000	9.000	A2200080156060	1 2 3 4 5 6 7 8	■
SFL 08015.06	NK 80	80	15	6	40	6.000	9.000	A2200080156080	1 2 3 4 5 6 7 8	■
SFL 08015.06	NK 120	80	15	6	40	6.000	9.000	A2200080156120	1 2 3 4 5 6 7 8	■
SFL 08015.06	NK 150	80	15	6	40	6.000	9.000	A2200080156150	1 2 3 4 5 6 7 8	■
SFL 08015.06	NK 240	80	15	6	40	6.000	9.000	A2200080156240	1 2 3 4 5 6 7 8	■
SFL 08015.06	NK 320	80	15	6	40	6.000	9.000	A2200080156320	1 2 3 4 5 6 7 8	■
SFL 08020.06	NK 60	80	20	6	40	6.000	9.000	A2200080206060	1 2 3 4 5 6 7 8	■
SFL 08020.06	NK 80	80	20	6	40	6.000	9.000	A2200080206080	1 2 3 4 5 6 7 8	■
SFL 08020.06	NK 120	80	20	6	40	6.000	9.000	A2200080206120	1 2 3 4 5 6 7 8	■
SFL 08020.06	NK 150	80	20	6	40	6.000	9.000	A2200080206150	1 2 3 4 5 6 7 8	■
SFL 08020.06	NK 240	80	20	6	40	6.000	9.000	A2200080206240	1 2 3 4 5 6 7 8	■
SFL 08030.06	NK 40	80	30	6	40	6.000	9.000	A2200080306040	1 2 3 4 5 6 7 8	■
SFL 08030.06	NK 60	80	30	6	40	6.000	9.000	A2200080306060	1 2 3 4 5 6 7 8	■
SFL 08030.06	NK 80	80	30	6	40	6.000	9.000	A2200080306080	1 2 3 4 5 6 7 8	■
SFL 08030.06	NK 120	80	30	6	40	6.000	9.000	A2200080306120	1 2 3 4 5 6 7 8	■
SFL 08030.06	NK 150	80	30	6	40	6.000	9.000	A2200080306150	1 2 3 4 5 6 7 8	■
SFL 08030.06	NK 320	80	30	6	40	6.000	9.000	A2200080306320	1 2 3 4 5 6 7 8	■
SFL 08040.06	NK 60	80	40	6	40	6.000	9.000	A2200080406060	1 2 3 4 5 6 7 8	■

The stated maximum operating speed only applies to a maximum overhang L_0 of 20 mm. Other overhang dimensions must be calculated separately.

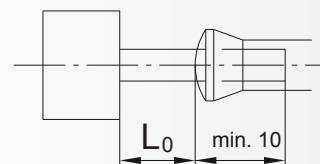

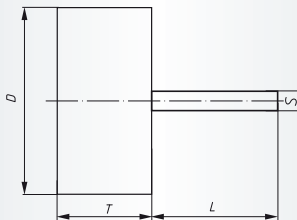
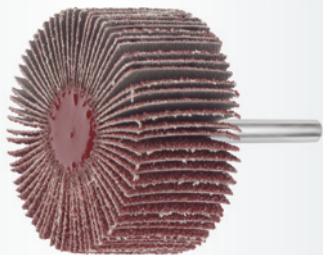
SFL, Flap wheels
Ordering example: A2200080506150

Packing unit:

10 pcs. per type

Further dimensions, qualities and shank lengths on request

NK = reg. Aluminium Oxide

Description	Grits	D mm	T mm	S mm	L mm	n recom. (1/min)	n max. (1/min)	Product-Number	recommended for	
SFL 08040.06	NK 80	80	40	6	40	6.000	9.000	A2200080406080	① ② ③ ④ ⑤ ⑥ ⑦ ⑧	■
SFL 08040.06	NK 150	80	40	6	40	6.000	9.000	A2200080406150	① ② ③ ④ ⑤ ⑥ ⑦ ⑧	■
SFL 08050.06	NK 40	80	50	6	40	6.000	7.500	A2200080506040	① ② ③ ④ ⑤ ⑥ ⑦ ⑧	■
SFL 08050.06	NK 60	80	50	6	40	6.000	7.500	A2200080506060	① ② ③ ④ ⑤ ⑥ ⑦ ⑧	■
SFL 08050.06	NK 80	80	50	6	40	6.000	7.500	A2200080506080	① ② ③ ④ ⑤ ⑥ ⑦ ⑧	■
SFL 08050.06	NK 120	80	50	6	40	6.000	7.500	A2200080506120	① ② ③ ④ ⑤ ⑥ ⑦ ⑧	■
SFL 08050.06	NK 150	80	50	6	40	6.000	7.500	A2200080506150	① ② ③ ④ ⑤ ⑥ ⑦ ⑧	■
SFL 08050.06	NK 240	80	50	6	40	6.000	7.500	A2200080506240	① ② ③ ④ ⑤ ⑥ ⑦ ⑧	■
SFL 08050.06	NK 320	80	50	6	40	6.000	7.500	A2200080506320	① ② ③ ④ ⑤ ⑥ ⑦ ⑧	■
SFL 10040.08	NK 40	100	40	8	40	5.000	7.500	A2200100408040	① ② ③ ④ ⑤ ⑥ ⑦ ⑧	■
SFL 10040.08	NK 60	100	40	8	40	5.000	7.500	A2200100408060	① ② ③ ④ ⑤ ⑥ ⑦ ⑧	■
SFL 10050.08	NK 60	100	50	8	40	5.000	7.500	A2200100508060	① ② ③ ④ ⑤ ⑥ ⑦ ⑧	■
SFL 10050.08	NK 80	100	50	8	40	5.000	7.500	A2200100508080	① ② ③ ④ ⑤ ⑥ ⑦ ⑧	■
SFL 10050.08	NK 150	100	50	8	40	5.000	7.500	A2200100508150	① ② ③ ④ ⑤ ⑥ ⑦ ⑧	■

The stated maximum operating speed only applies to a maximum overhang L_0 of 20 mm. Other overhang dimensions must be calculated separately.

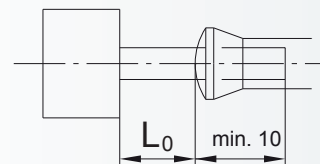

Material classification

- 1 STEELS AND CAST STEELS**
Rm up to 800 N/mm²
 - common structural steels
 - free cutting steels
 - case hardened steels
 - fine grained structural steels
 - extruded steels
 - toughened structural steels
 - boiler plate
 - nitrided steels
 - cast steels
 - heat treated steels
 - heat resistant structural steels
- 2 ALLOYED, TEMPERED STEELS**
Rm 800 up to 1200 N/mm²
 - case hardened steels
 - spring steels
 - fine grained structural steels
 - nitrided steels
 - heat treated steels
 - wear resistant steels
 - bearing steels
- 3 TOOL STEELS** Rm up to 1300 N/mm²
 - 60 - 65 HRC
 - high-speed steels
 - non-alloyed tool steels
 - cold working tool steels
 - hot working tool steels
- 4 RUST, ACID AND HEAT RESISTANT STEELS AND CAST STEELS**
 - austenitic
 - ferritic
 - ferritic-austenitic
 - heat-resistant
 - martensitic
 - stainless, sulphurized

- 5 CAST IRON**
- 6 ALUMINIUM, MAGNESIUM AND COPPER ALLOYS**
 - over 300 HB
 - 200-300 HB
 - up to 200 HB
 - over 15% Si
 - 10-15% Si
 - 0,5-10% Si
 - below 0,5% Si
- 7 TITANIUM AND NICKEL ALLOYS**
 - Rm 900 up to 1500 N/mm²
 - Rm up to 900 N/mm²
- 8 PLASTICS, WOOD, RUBBER**
- 9 GLASS / CARBIDES**
- 10 STONE / TILES / GAS CEMENT**
- 11 CONCRETE / REINFORCED CONCRETE**
- 12 CERAMIC / FLOOR TILES**
- 13 MARBLE**
- 14 GRANITE**
- 15 FRESHLY POURED CONCRETE**
- 16 ASPHALT**

- best suitable
- suitable
- delivery ex-stock
- ▲ delivery on request
- Ⓢ regrind service, please enquire

Safety Symbols

			
Wear eye protection	Wear hearing protection	Wear a respirator	Read the instructions
			
Wear gloves	Only permitted with a back-up pad		
			
Not permitted for wet grinding	Not permitted for face grinding	Do not use if damaged	Do not use for freehand cutting